

LAASYA LAKEVIEW (BBMP A KHATHA) LAYOUT: ELECTRONIC CITY, BANGALORE

Laasya Lakeview – Profile

LAASYA Lakeview is indeed the most phenomenal project with its connectivity to the IT Hub of Bangalore and Electronics City, making it worth investing. The natural appeal, parks and the fresh environment creates a refreshing atmosphere for living comfort with a majestic living experience. The venture is 1.5 kilometers from Electronic City and close to Infosys, Wipro and other major IT companies. The company motto is to provide maximum satisfaction with exclusive and trendy styles. We understand that a house is not just a four walled compartment; it is a place where love and affection takes birth with feelings, emotions and captured with pleasant moments. Our endeavor is to provide this memorable to our esteemed customers.

Laasya Lakeview: Amenities and Facilities

A distinct and world class venture to equip your dream house with requisite luxuries and amenities, to keep you joyful, contented and lively. The daily schedule of human life has restricted people into water tight compartments, and to get rid of this syndrome, LAASYA Lakeview offers you a layout close to a lake with a landscaped garden and walk way spaced with rest bays for you to walk, rest and recoup. Besides, the amenities include:

- Round the clock security.
- All round compound walls.
- Electricity and Water supply.
- Street Lights.
- Storm water drainage.
- Underground Sewerage.
- Asphalted road.
- Kids play area.
- Landscaped Walking Track.
- Tree Lined Roads.

Laasya Lakeview: Location Highlights

- 1.5 Kms from Electronic City.
- Close to Wipro, Infosys and other major Companies.
- 5 Kms from Silk Board and Madivala.
- Walkable distance from Hosa Road circle off Hosur Road.
- 10minute's drive from Sarjapur Road.
- Surrounded by many International schools.
- Amidst upcoming townships.

Laasya Lakeview: Hospitals Close By

- Srujana Hospital (2.3 Kms/10 Mins)
- Archana Medical (2.8 Kms/10 Mins)
- The Apollo Hospital (4.3 Kms/20 Mins)
- Ramakrishna Healthcare & Trauma Centre (4.8 Km/s 20 Mins)
- Sri Vinayaka Gen & Maternity Hosp (5 Kms/20 Mins)
- Narayana Hrudayalaya Institute Of Cardiac Science (10kms/30mins)
- Patanjali Arogyakendra (3.6 Kms/15 Mins)
- Swamy Trauma Centre & Maternity Hospital (4.4 Kms/20 Mins)
- Infosys Medical Center (5.1 Kms/20 Mins)
- Lakshmi Nursing Home (8.2 Kms/30 Mins)
- Blossom Multispecialty Clinic and Diagnostics Centre (5.2 Kms/20 Mins)
- Sparsh Hospital (7 Kms/25 Mins)
- Mazumdar Shaw Cancer Centre (10 Kms/30 Mins)
- Fortis Hospital (5 Kms/15 Mins)

Laasya Lakeview: Schools Close By

- Euro Kids (2.7 Kms/15 Mins)
- VIBGYOR HIGH (1 Km/5 Mins)
- Candor International School (2 Kms/10 Mins)
- Vidyarambh (2.3 Kms/15 Mins)
- St. Xaviers (2 Kms/10 Mins)
- Gurukula Academy (3 Kms/15 Mins)
- Crewzincrew Dance Studio (2.9 Kms/15 Mins)
- Juzzkidz Daycare and Playschool (2.7 Kms/15 Mins)
- Christ Academy (2 Kms/10 Mins)
- Redbridge International Academy (3.5 Kms/20 Mins)
- Sri Chaitanya International Residential School (5 Kms/20 Mins)
- Sorsfort International School (2 Kms/10 Mins)
- Ebenezer International School (5 Kms/25 Mins)
- Treamis International School (5 Kms/25 Mins)

Laasya Lakeview: Malls Close By

- Total Mall (10 Kms/20 Mins)
- Central Mall (15 Kms/30 Mins)
- Oasis Mall(15 Kms/30 Mins)
- Forum Mall(10 Kms/20 Mins)
- D Mart (5 Kms/10 Mins)
- Meenakshi Mall (7 Kms/20 Mins)
- Gopalan Mall (7 Kms/20 Mins)

Laasya Lakeview: Temples Close By

- Sri Shirdi Sai Baba Temple (10 Kms/45 Mins)
- Sri Shirdi Sai Baba Temple (10 Kms/45 Mins)
- Sri Jagannath Temple (10 Kms/45 Mins)
- Sri Shirdi Saibaba Mutt (10 Kms/45 Mins)
- Sri Hari Vaikunta Kshetra Trust (10 Kms/45 Mins)
- Varasidhi Vinayaka Temple (10 Kms/45 Mins)
- Sri Shirdi Sai Baba Temple (10 Kms/45 Mins)
- Sri Ayyappan Temple (10 Kms/45 Mins)

Laasya Lakeview: Layout Plan

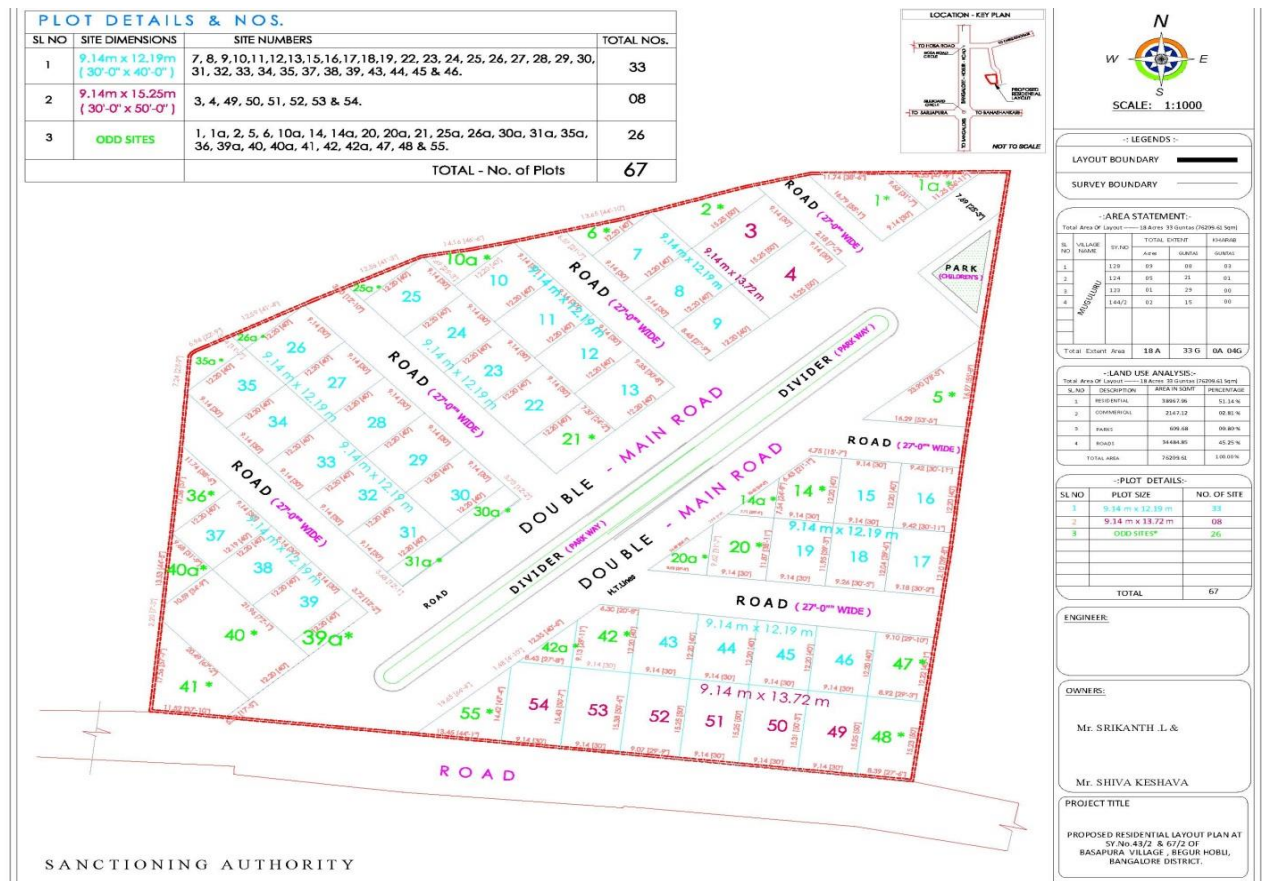

Area Statement:

LAASYA LAKE VIEW - RESIDENCY								
AREA STATEMENT ANALYSIS								
SINo	PLOT NO	DIMENSIONS			AREA	UNIT	FACING	OLD - PLOT NO.
1	1	ODD SITE *			1330	SFT	SOUTH WEST & SOUTH EAST	
2	1a	ODD SITE *			583	SFT	SOUTH EAST	
3	2	ODD SITE *			984	SFT	NORTH EAST	
4	3	30'-0" x 50'-0"			1500	SFT	NORTH EAST	
5	4	30'-0" x 50'-0"			1500	SFT	NORTH EAST	
6	5	ODD SITE *			1487	SFT	NORTH WEST & SOUTH	
7	6	ODD SITE *			468	SFT	SOUTH WEST	
8	7	30'-0" x 40'-0"			1200	SFT	SOUTH WEST	
9	8	30'-0" x 40'-0"			1200	SFT	SOUTH WEST	
10	9	30'-0" x 40'-0"			1200	SFT	SOUTH WEST	
11	10	30'-0" x 40'-0"			1200	SFT	NORTH EAST	
12	10a	ODD SITE *			521	SFT		
13	11	30'-0" x 40'-0"			1200	SFT	NORTH EAST	
14	12	30'-0" x 40'-0"			1200	SFT	NORTH EAST	
15	13	30'-0" x 40'-0"			1200	SFT	NORTH EAST	
16	14	ODD SITE *			1090	SFT	NORTH & NORTH WEST	
17	14a	ODD SITE *			288	SFT	NORTH WEST	
18	15	30'-0" x 40'-0"			1200	SFT	NORTH	
19	16	30'-0" x 40'-0"			1200	SFT	NORTH	
20	17	30'-0" x 40'-0"			1200	SFT	SOUTH	
21	18	30'-0" x 40'-0"			1200	SFT	SOUTH	
22	19	30'-0" x 40'-0"			1200	SFT	SOUTH	
23	20	ODD SITE *			1139	SFT	SOUTH	
24	20a	ODD SITE *			465	SFT	SOUTH & NORTH WEST	
25	21	ODD SITE * (24'-0" x 40'-0")			960	SFT	SOUTH WEST & SOUTH EAST	
26	22	30'-0" x 40'-0"			1200	SFT	SOUTH WEST	
27	23	30'-0" x 40'-0"			1200	SFT	SOUTH WEST	
28	24	30'-0" x 40'-0"			1200	SFT	SOUTH WEST	
29	25	30'-0" x 40'-0"			1200	SFT	SOUTH WEST	
30	25a	ODD SITE *			286	SFT	SOUTH WEST	
31	26	30'-0" x 40'-0"			1200	SFT	NORTH EAST	
32	26a	ODD SITE *			259	SFT		
33	27	30'-0" x 40'-0"			1200	SFT	NORTH EAST	
34	28	30'-0" x 40'-0"			1200	SFT	NORTH EAST	
35	29	30'-0" x 40'-0"			1200	SFT	NORTH EAST	
36	30	30'-0" x 40'-0"			1200	SFT	NORTH EAST	
37	30a	ODD SITE *			484	SFT	NORTH EAST & SOUTH EAST	
38	31	30'-0" x 40'-0"			1200	SFT	SOUTH WEST	
39	31a	ODD SITE *			484	SFT	NORTH EAST & SOUTH EAST	
40	32	30'-0" x 40'-0"			1200	SFT	SOUTH WEST	
41	33	30'-0" x 40'-0"			1200	SFT	SOUTH WEST	
42	34	30'-0" x 40'-0"			1200	SFT	SOUTH WEST	
43	35	30'-0" x 40'-0"			1200	SFT	SOUTH WEST	
44	35a	ODD SITE *			489	SFT		
45	36	ODD SITE *			808	SFT	NORTH EAST	
46	37	30'-0" x 40'-0"			1200	SFT	NORTH EAST	
47	38	30'-0" x 40'-0"			1200	SFT	NORTH EAST	

48	39	30'-0" x 40'-0"	1200	SFT	NORTH EAST	
49	39a	ODD SITE *	495	SFT	NORTH EAST & SOUTH EAST	
50	40	ODD SITE *	2879	SFT	SOUTH EAST	
51	40a	ODD SITE *	546	SFT		
52	41	ODD SITE *	1673	SFT	SOUTH EAST & SOUTH	
53	42	ODD SITE *	1143	SFT	NORTH	
54	42a	ODD SITE *	385	SFT	NORTH WEST	
55	43	30'-0" x 40'-0"	1200	SFT	NORTH	
56	44	30'-0" x 40'-0"	1200	SFT	NORTH	
57	45	30'-0" x 40'-0"	1200	SFT	NORTH	
58	46	30'-0" x 40'-0"	1200	SFT	NORTH	
59	47	ODD SITE *	1214	SFT	NORTH	
60	48	ODD SITE *	1450	SFT	SOUTH	
61	49	30'-0" x 50'-0"	1500	SFT	SOUTH	
62	50	30'-0" x 50'-0"	1500	SFT	SOUTH	
63	51	30'-0" x 50'-0"	1500	SFT	SOUTH	
64	52	30'-0" x 50'-0"	1500	SFT	SOUTH	
65	53	30'-0" x 50'-0"	1500	SFT	SOUTH	
66	54	30'-0" x 50'-0"	1500	SFT	SOUTH	
67	55	ODD SITE *	1044	SFT	SOUTH & NORTH WEST	

TOTAL - SALEABLE AREA OF LAYOUT	74553.73	SFT	6928.79	SQM
--	-----------------	-----	---------	-----

6928.79

a	Children's Park Area	1422.47	SFT	132.20	SQM
	Divider Cum Park	6660	SFT	618.96	SQM

b	Layout Road Area	43265	SFT	4020.91	SQM
---	------------------	-------	-----	---------	-----

TOTAL - LAYOUT AREA	125901.20	SFT	11700.86	SQM
----------------------------	------------------	-----	-----------------	------------

2 ACRE - 35 GUNTAS

	PLOTS DIMENSIONS	Nos
1	30'-0" x 40'-0"	33
2	30'-0" x 50'-0"	8
3	ODD Sites	26
	TOTAL PLOTS	67

Availability Of Plots as on 02 Jul 2014

Plot No	Dimensions (Ft)	Area	Facing	Plot No	Dimensions (Ft)	Area	Facing
1 & 1A	Odd Site	1913	South	30A		484	North
2	Odd Site	984	North	31	30*40	1200	South
3	30*50	1500	North	31A	Odd Site	484	South & East
4	30*40	1500	North	35	30*40	1200	South
5	30*40	1487	South	35A	Odd Site	489	South
6	Odd Site	468	South	36	Odd Site	808	North
7	30*40	1200	South	37	30*40	1200	North
9	30*40	1200	South	39A	Odd Site	495	North
10	30*40	1200	North	40	Odd Site	2879	East
10A	Odd Site	521	North	40A	Odd Site	546	
14	Odd Site	1090	North	41	Odd Site	1673	South East
14A	Odd Site	288	North	42	Odd Site	1143	North
20	Odd Site	1139	South	42A	Odd Site	385	North
20A	Odd Site	465	South	51	30*50	1500	South
25	30*40	1200	South	52	30*50	1500	South
25A	Odd Site	286	South	53	30*50	1500	South
				55	30*50	1044	S & NW

Laasya Lakeview: Area & Cost

Type	Size (Ft)	Area (Sq Ft)	Facing	Rate Per Sq Ft	Cost
Plot	30 x 40	1200	North East & South	Rs 3200	38.40 Lakhs
Plot	30 x 50	1500	North East & South	Rs 3200	48 Lakhs
Plot		3200 (approx.)	East	Rs 3200	

Laasya Lakeview: Payment Plan

- On booking: Rs. 50,000/- . **(Return of full amount if booking cancelled in 5 days).**
- On Agreement within in the next 07 days: 30%
- On registration within next 15 days: Balance amount.

Laasya Lakeview: Bank Loan: Available from Nationalized and Private Banks.

Laasya Lakeview: Contact Details

- ✓ Phone : +91 - 80 – 2572 7770, +91 - 80 - 4920 2323
- ✓ Email : info@laasyaprojects.com

Lakeview Gallery:

Layout View 1 (Arch and Gate)



Layout View 2(Security Room)



Layout View 3 (View of 30 ft Layout Road Being Metalled)



Layout View 4 (Western View of Layout)



Layout View 5 (Eastern View of Layout Towards Temple)



Layout View 6 (Approach Road to Layout)



Layout View 7 (Landscaped Walkway)

